

Part number

# MAVR 24.40



Hood, 180 °C series, with 4 pegs, M40 top cable entry, size "104.27", high construction

#### Product description

<b>Product type</b>	Hood
<b>Series</b>	180 °C
<b>Closing type</b>	With 4 pegs
<b>Size</b>	Size "104.27"
<b>Cable entry</b>	Top cable entry with adapter M40
<b>Specification</b>	High construction

#### Technical data

<b>IP degree of protection</b>	IP65 / IP66 / IP69
--------------------------------	--------------------

#### Further technical details

<b>Weight</b>	210,00 g
<b>Operating temperature range (min, max)</b>	-40°C ... +180°C

#### Material properties

<b>RoHS conformity</b>	Compliant
<b>China RoHS - EFUP</b>	E
<b>REACH SVHC substances</b>	No

#### Approvals / Standards

<b>Certifications</b>	DNV, BV
<b>UL</b>	ECBT2
<b>cUL</b>	ECBT8

#### General ordering information

<b>EAN13 code</b>	8015747115438
<b>eCl@ss 8.1</b>	27440202
<b>ETIM 7.0</b>	EC000437

#### Packaging Information

<b>Sub-packaging weight</b>	1,05 kg
<b>Sub-packaging description</b>	Plastic packaging
<b>Sub-packaging quantity</b>	5 Pcs
<b>Sub-packaging EAN barcode</b>	8015747115452

Part number

# MAVR 24.40



## Catalogue drawings

### CHOR (CAOR) - MHOR (MAOR)

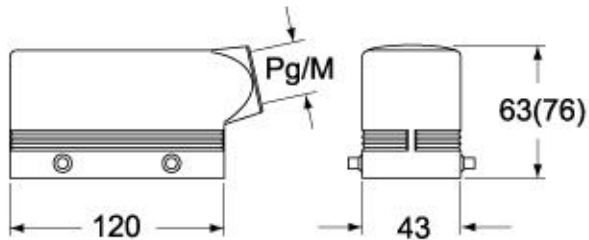

### CHVR (CAVR) - MHVR (MAVR)

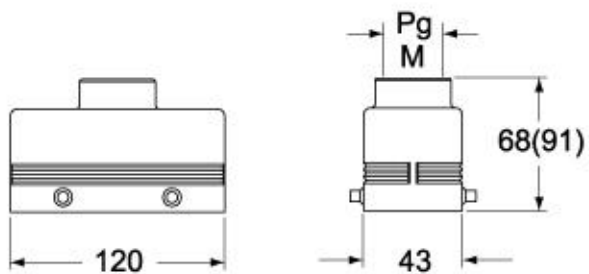

### CHCR G

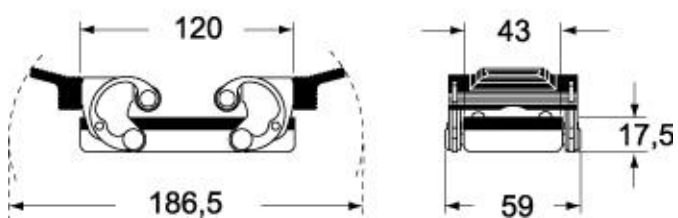

## Notes

ITEM NO LONGER AVAILABLE

Alternative products:  
MFVR 24.40

---

Dimensions shown in mm are not binding and may be changed without notice.

---